

PE Electrofusion Fittings

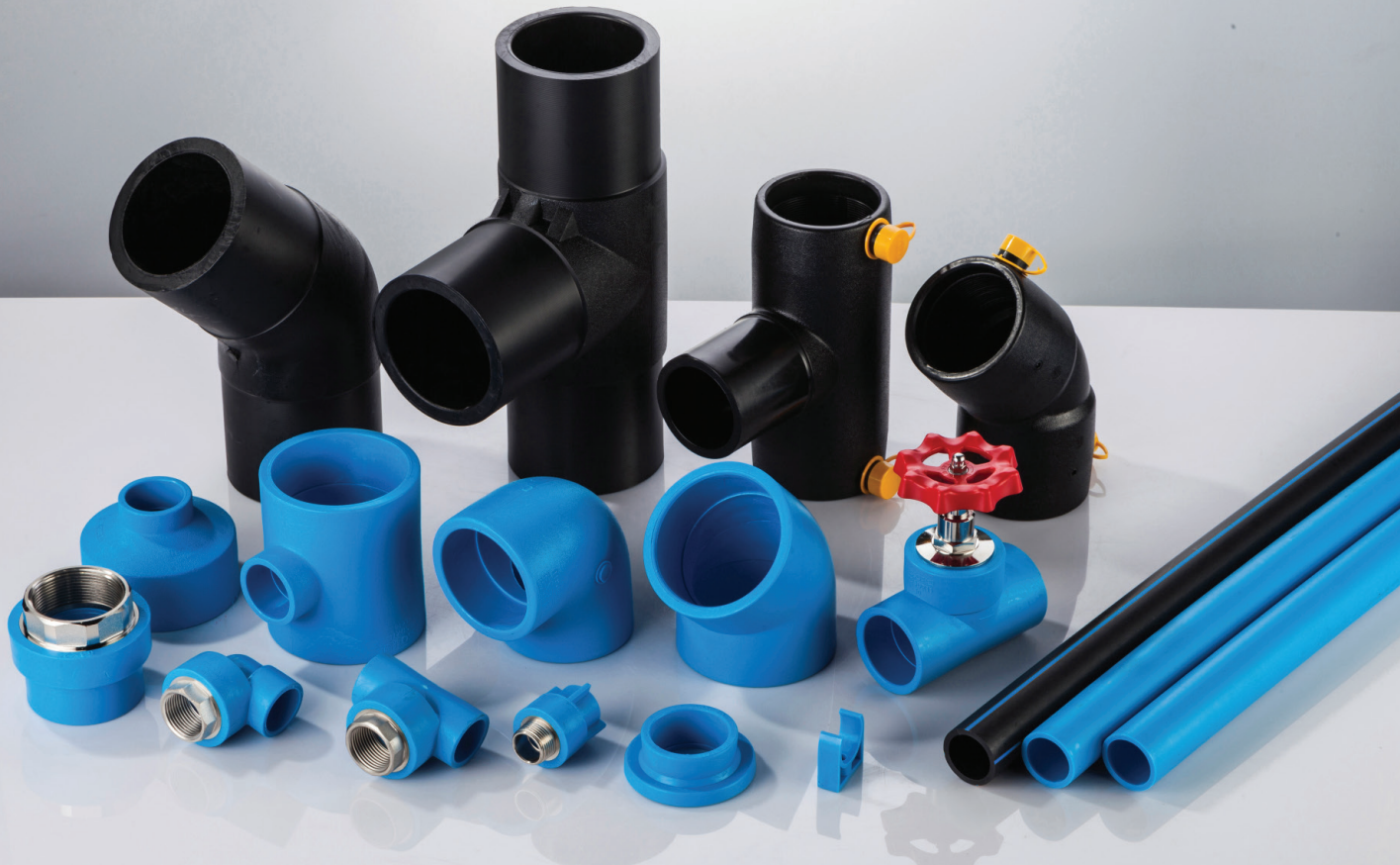



CHINA LESSO GROUP HOLDINGS LIMITED

China Lesso Group Holdings Limited (Stock Name: China Lesso, Stock Code: 02128.HK) is a large industrial group of home furnishings and building materials in China. China Lesso's business portfolio spans plastic piping, building materials and home furnishings, environmental protection, supply-chain service platforms and the photovoltaic sector. It offers products such as pipes, photovoltaics, plumbing and sanitary ware, integral kitchen materials, integral doors and windows, aluminum formwork and smart scaffolds, water purifiers, water-proofing materials and sealants, fire-fighting equipment, valves, cables, lighting, hygiene materials, items for environmental protection, agricultural facilities, and oceanic aquaculture cages. Its sales revenue has reached RMB 32.058 billion in 2021.

With the rapid development of internationalization and globalization, China Lesso boasts more than 30 advanced production bases distributed in 18 provinces across China, and in some foreign countries. China Lesso remains committed to improving its strategic layout, broadening its sales network and expanding the market. This is how it provides products and services for customers in a timely and efficient way.

China Lesso has established its R&D center with more than 1,000 scientific researchers. The Group now possesses twenty-eight national high-tech enterprises, one national accredited enterprise technology center, two post-doctoral workstations, five China national accredited laboratories authorized by CNAS, one key enterprise laboratory of plastics molding and processing technology in Guangdong Province, and one union of Technical Innovation of Plastic Pipe Industry in Guangdong Province.

China Lesso owns over 2200 patents (some of them are pending). Some of Lesso's scientific achievements are included in National Torch Plan Projects, National Key New Product, Scientific Achievements Promotion Projects in National Construction Industry and Government Green Procurement List. The Group has been awarded many honorary titles and prizes, such as Champion Manufacturer, China Construction Independent Science Innovation Superior Enterprise, Intellectual Property Right Preponderant Enterprise, Industrialization Demonstration Base, Outstanding Patent Owner in China, Guangdong Provincial Government Quality Prize, and the First Prize of Scientific Technological Progress in Guangdong Province, and the First Prize of Scientific Technological Progress of China Light Industry Association.

As a domestic manufacturer of extensive home furnishings and building materials, China Lesso provides over 10,000 varieties of products with all specifications. Its products are being widely used in many areas, including home decoration, civil construction, municipal water supply, drainage, power supply and telecommunications, gas supply, fire-fighting, environmental protection, agriculture, oceanic aquaculture, and photovoltaic power generation.

True to its slogan of "Envisioning the Better, Building the Future", China Lesso will honor its promise of creating a healthy, enjoyable, and sustainable environment. The Group remains committed to improvements in urban construction to create better places to live. With concerted efforts from various sectors, Lesso will fully play its role in building green, livable, and efficient cities so that people could enjoy health and happiness anytime and anywhere in their city life.



LESSO Research Institute & Testing Center



LESSO College



Training Apartment



LESSO Headquarter

FEEL THE BETTER LIFE

Pipes, Building Materials and Home Furnishings,
Environmental Protection, Channels and Services



Contents

PE Electrofusion Fittings

Electro Fusion Fittings	01-08
Installations: Electro Fusion Joint	09
Installations: Transition Joint	10
Installations: Trenchless Technology	11

Illustration of commercial mark included
in pipes's and fittings' publicity materials:

LESSO  **LIANSU L&S**

All above trademarks are registered trademarks of
Guangdong lesso technology Industrial Co., LTD.
Please be informed that the products labeled those trademarks are
products of lesso Group Company Limited. All rights reserved.



■ Features

Material: PE 100

Size: full 20mm through 400mm availability

Pressure Rating: 1.6MPa or other nominal pressures available upon request

Standard: ISO 4427-3, EN 12201-3, BS EN 12201-3 AS/NZS 4129 BS 6920, MS 1058 - 3

Color: blue, black or other colors available upon request

Joint: joining pipe and electro fusion fittings by electro fusion joint



■ Advantages

Non-toxic: no heavy metal additives, would not be covered with dirt or contaminated by bacterium

Corrosion Resistance: resist chemical matters and electron chemical corrosion

Low Installation Costs: light weight and ease of installation can reduce installation costs

High Flow Capacity: smooth interior walls result in low pressure loss and high volume

Longevity: more than 50 years under proper use

E/F Reducer

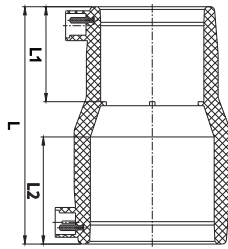

SAP Number (black)	Size (mm)	L	L1	L2	PCS/CTN
8010040493	32×25	89	41	44	250
8010040496	40×32	105	44	49	150
8010040497	50×32	115	44	55	126
8010040498	50×40	115	49	55	100
8010040499	63×32	130	44	63	72
8010040500	63×40	130	49	63	72
8010040501	63×50	130	55	63	70
8010040502	75×63	145	63	70	48
8010040503	90×63	175	63	79	28
8010040504	90×75	175	70	79	28
8010040474	110×50	160	55	82	24
8010040475	110×63	180	63	82	20
8010040476	110×75	180	70	82	24
8010040477	110×90	180	79	82	20
8010040478	125×90	195	79	87	14
8010040481	160×90	224	79	98	6
8010040479	160×110	224	82	98	6
8010040485	★ 200×63	250	63	112	5
8010040482	200×110	250	82	112	4
8010040483	200×160	250	98	112	4
	★ 225×110	255	82	120	
	★ 225×160	260	98	120	
8010040487	250×110	280	82	129	3
8010040488	250×160	280	98	129	2
8010040489	250×200	280	112	129	2
8010040490	315×160	320	98	150	
8010040491	315×200	320	112	150	1
8010040492	315×250	320	129	150	1
8010040494	400×200	370	112	179	
8010040495	400×315	370	150	179	

New Type Electro Fusion Coupling

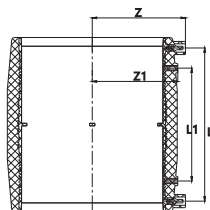

SAP Number (black)	Size (mm)	L	L1	Z	Z1	PCS/CTN
8010044891	90	131	87	69.5	45.4	
8010044821	110	137	93	68.5	55.4	
8010044468	160	175	129	106.4	97.7	
8010044825	200	183	137	126.5	123	

E/F Coupling

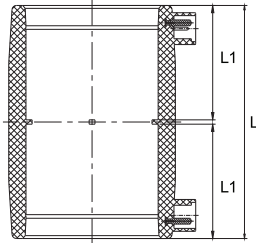

SAP Number (black)	Size (mm)	L	L1	PCS/CTN
8010040318	20	84	41	350
8010040321	25	84	41	320
8010040325	32	90	44	240
8010040327	40	100	49	180
8010040330	50	113	55	82
8010040332	63	129	63	54
8010040333	75	143	70	48
8010040334	90	161	79	32
8010040314	110	167	82	18
8010040315	125	177	87	12
8010040316	160	199	98	6
8010040317	180	213	105	4
8010040319	200	227	112	4
8010040320	225	243	120	2
8010040322	250	261	129	2
8010040323	280	273	135	2
8010040324	315	304	150	1
8010040326	355	332	164	1
8010040328	400	362	179	1
8010040329	450	394	194.5	
8010040331	500	429	212	
8010042122	560	476	234	
8010042123	630	546	270	

E/F 11.25° Elbow

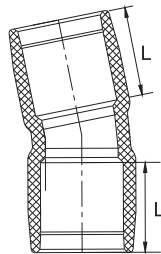

SAP Number (black)	Size (mm)	L	PCS/CTN
8010044792	50	55	46
8010044726	63	63	24
8010044728	75	70	30
8010044694	90	79	23

E/F 22.5° Elbow

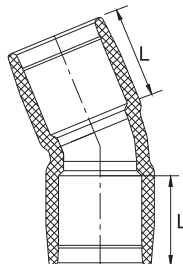

SAP Number (black)	Size (mm)	L	PCS/CTN
8010044793	50	55	42
8010044727	63	63	22
8010044729	75	70	30
8010044794	90	79	8

E/F 45° Elbow

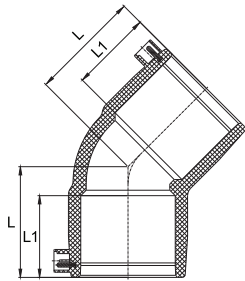

SAP Number (black)	Size (mm)	L	L1	PCS/CTN
8010040362	32	56	44	180
8010040363	40	64	49	120
8010040365	50	73	55	80
8010040366	63	85	63	50
8010040367	75	95	70	48
8010040368	90	107	79	20
8010040355	110	116	82	12
8010040356	125	127	87	8
8010040357	160	150	98	4
8010040358	180	157	105	3
8010040359	200	170	112	2
	★ 225	182	120	
8010040360	250	202	129	1
8010040361	315	238	150	
8010040364	400	280	179	

E/F 90° Elbow

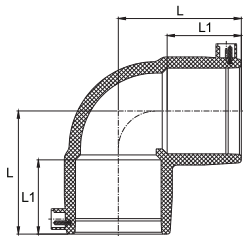

SAP Number (black)	Size (mm)	L	L1	PCS/CTN
8010040379	20	54	41	360
8010040381	25	56.2	41	240
8010040384	32	65	44	160
8010040385	40	74	49	100
8010040387	50	86	55	60
8010040388	63	100	63	40
8010040389	75	114	70	24
8010040390	90	131	79	16
8010040375	110	145	82	9
8010040376	125	159	87	6
8010040377	160	192	98	4
8010040378	180	206	105	2
8010040380	200	225	112	2
8010044643	★ 225	245	120	
8010040382	250	265	129	1
8010040383	315	320	150	
8010040386	400	395	179	

The product mold marked as "★" on this page has not been improved, please note.

E/ F Reducing Tee

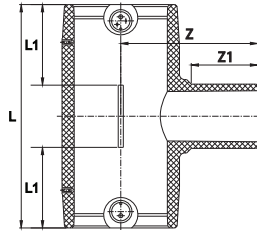

SAP Number (black)	Size (mm)	L	L1	Z1	Z	PCS/CTN
8010040434	32×20	107	44	43	70	130
8010040435	32×25	111.5	44	43	70	130
8010040441	40×20	118.5	49	43	76	90
8010040442	40×25	123	49	43	76	90
8010040443	40×32	129	49	46	79	90
8010040444	50×20	130.5	55	42	79.5	70
8010040445	50×25	135.8	55	43	81	65
8010040446	50×32	142.2	55	46	84	60
8010040447	50×40	149	55	51	89	60
8010040448	63×20	153	63	43	90	40
8010040449	63×25	158	63	43	90	40
8010040450	63×32	165.5	63	46	96	40
8010040451	63×40	172.5	63	51	101	40
8010040452	63×50	180.5	63	57	107	36
8010040453	75×40	186.3	70	51	109	
8010040454	75×50	194.2	70	57	115	
8010040455	75×63	204	70	65	123	
8010040456	90×40	197	79	51	120	16
8010040457	90×50	209.5	79	57	126	16
8010040458	90×63	219	79	65	134	15
8010040459	90×75	230	79	72	141	14
8010040403	110×50	218	82	57	140	10
8010040404	110×63	226	82	65	148	10

SAP Number (black)	Size (mm)	L	L1	Z1	Z	PCS/CTN
8010040405	110×75	238	82	72	155	9
8010040406	110×90	250	82	81	164	6
8010040408	125×63	239	87	65	160	6
8010040409	125×75	249.6	87	72	167	6
8010040410	125×90	261.6	87	81	175	6
8010040407	125×110	278.6	87	84	178	4
8010040412	160×50	249	98	57	174	4
8010040413	160×63	259	98	65	182	3
8010040414	160×75	270	98	72	189	3
8010040415	160×90	282	98	81	198	3
8010040411	160×110	298	98	84	201	
8010043150	180×160	352	105	100	230	2
8010040418	200×50	308	112	70	216	2
8010040419	200×63	308	112	70	216	
8010040420	200×75	308	112	81	227	
8010040421	200×90	308	112	81	227	2
8010040416	200×110	365	112	100	245	2
8010040417	200×160	365	112	100	245	
8010040425	250×50	330	129	80	252	
8010040426	250×63	330	129	80	252	
8010040427	250×75	330	129	80	254	
8010040428	250×90	358	129	90	265	1
8010040422	250×110	358	129	90	265	1
8010040423	250×160	430	129	110	291	1
8010040424	250×200	430	129	120	291	
8010040433	315×90	440	150	100	325	
8010040429	315×110	440	150	100	325	
8010040430	315×160	440	150	105	325	
8010040431	315×200	514	150	120	346	
8010040432	315×250	514	150	134	346	
8010040436	400×110	453	179	82	355	
8010040437	400×160	526	179	110	390	
8010040438	400×200	526	179	112	390	
8010040439	400×250	619	179	134	415	
8010040440	400×315	619	179	163	425	

Nominal Pressure is available in 0.6MPa, 1.0MPa and 1.6MPa.

E/F Tee

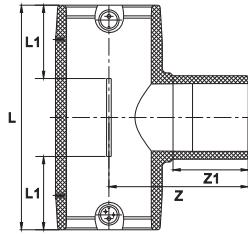

SAP Number (black)	Size (mm)	L	L1	Z1	Z	PCS/CTN
8010040289	20	98	41	42	60.5	180
8010040291	25	102	41	42	63	
8010040294	32	118	44	46	73	120
8010040295	40	136	49	51	84	70
8010040297	50	157	55	57	95	48
8010040298	63	190	63	65	115	30
8010040299	75	215	70	72	130	20
8010040300	90	242	79	81	150	12
8010040285	110	266	82	86	167	7
8010040286	125	290	87	89	181	5
8010040287	160	338	98	105	222	3
8010040288	180	368	105	107	237	2
8010040290	200	398	112	115	255	1
8010044640	★ 225	460	120	129	290	
8010040292	250	472	129	135	301	1
8010040293	315	567	150	150	360	
8010040296	400	690	179	179	440	

E/F Tapping Saddle



SAP Number (black)	Size (mm)	PCS/CTN
8010042710	63×25	
8010042711	63×32	
8010042712	75×32	
8010042713	90×32	
8010042714	90×63	12
8010042715	110×32	
8010042716	110×40	
8010042717	110×63	10
8010042718	125×32	
8010042719	125×63	
8010042720	160×32	
8010042721	160×63	5
8010042722	180×32	
8010042723	180×63	
8010042724	200×32	
8010042725	200×63	
8010042726	200×90	4
8010042727	250×90	3
8010042728	★ 315×110	
8010042729	★ 315×160	

The product mold marked as "★" on this page has not been improved, please note.

E/F Straight Saddle



SAP Number (black)	Size (mm)	PCS/CTN
8010042696	75×63	
8010042697	90×63	40
8010042698	110×63	30
8010042699	125×63	
8010042700	160×63	
8010042701	180×63	
8010042702	200×63	12
8010042703	200×90	12
8010042704	★ 250×63	
8010042705	250×90	12
8010042706	★ 315×63	
8010042707	★ 315×90	
8010042708	315×110	4
8010042709	315×160	3

E/F Stop Saddle



SAP Number (black)	Size (mm)	PCS/CTN
8010041359	90	36
8010041353	110	30
8010041354	125	30
8010041355	160	30
8010041356	200	20
8010041357	250	
8010041358	315	8

The product mold marked as "★" on this page has not been improved, please note.

E/F Stub Flange

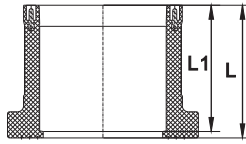

SAP Number (black)	Size (mm)	L	L1	PCS/CTN
8010043684	50	62	55	
8010043692	63	66	63	
8010043685	75	73	70	
8010042116	90	81	79	
8010040278	160	128	125	12
8010040279	200	138	134	6
8010040280	250	142	138	3
8010040281	315	159	150	2
8010040282	400	185	175	
8010040283	500	220	210	
8010043074	630	283	255	

E/F Stub Flange (short)

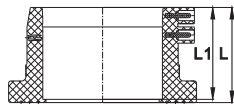

SAP Number (black)	Size (mm)	L	L1	PCS/CTN
8010043075	110	88	85	

E/F Flange (Steel Tray)

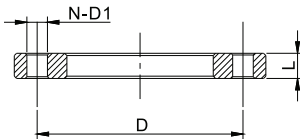

SAP Number (black)	Size (mm)	N	D1	D	L	PCS/CTN
8010043104	50	4	18	75	10	
8010043105	63	4	18	82.5	12	
8010043106	75	4	18	92.5	15	
8010042113	90	8	19	100	15	
8010040267	110	8	18	180	22	3
8010040268	160	8	22	240	24	1
8010040269	200	12	22	295	26	1
8010040270	250	12	26	355	29	1
8010040271	315	12	26	410	32	1
8010040273	400	16	30	525	36	1
8010040274	500	20	33	650	44	
8010043076	630	20	36	770	54	

(3) Electro Fusion Joint Step: (Use Electro Fusion Welding Machine)

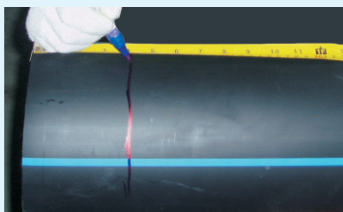

① Clean and mark

- Clean up the connection part, mark the inserting depth.

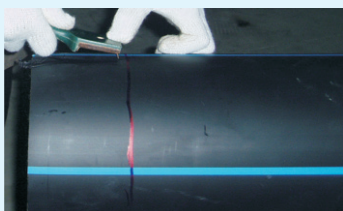

② Scrape

- Scrape and polish the joint surface.



③ Align and restrain the fittings to the pipes



④ Apply electric current

- Apply the electric current to the fittings; the joining parts will be heated and melted, turn off the current when there is melt flowing in the observation hole.



⑤ Cool

- Cool without movement or pressure.

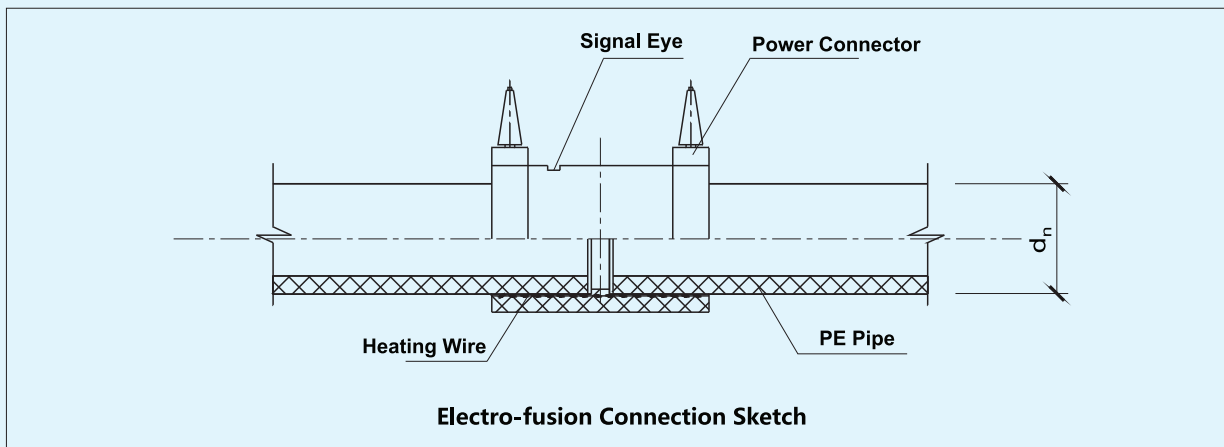

Note: While connecting, the heating voltage and time should comply with manufacture's technical stipulations of Electro Fusion Welding Machine.

(4) Transition Joint

Join the PE pipe and the iron pipe by Flange Joint

① Preparation

- Prepare the necessary tools and accessories. ■ Check and clean the accessories.

② Put the pipe in the flange tray.

③ Use socket fusion joint or butt fusion joint on the pipe and the flange stub.

④ Put the rubber ring between the two flange stubs, and then tighten the bolts.

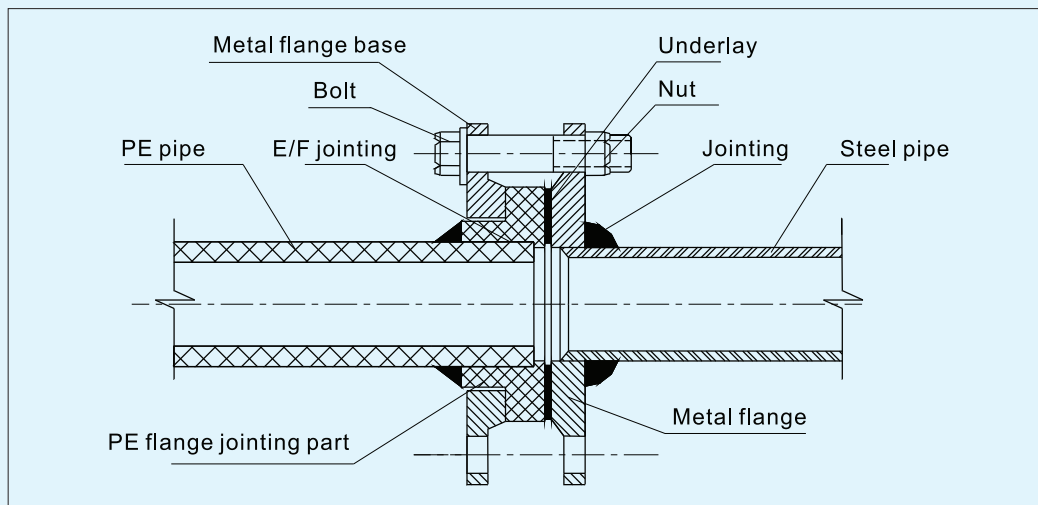

Trenchless Technology

The technology of detecting, laying, repairing and changing various kinds of pipe by no excavation or less excavation.

Horizontal Directional Drilling Technology

The installation technology of directional drilling, chambering and pulling the pipe from different depth and different stratum by using the directional drilling equipments and location apparatus.

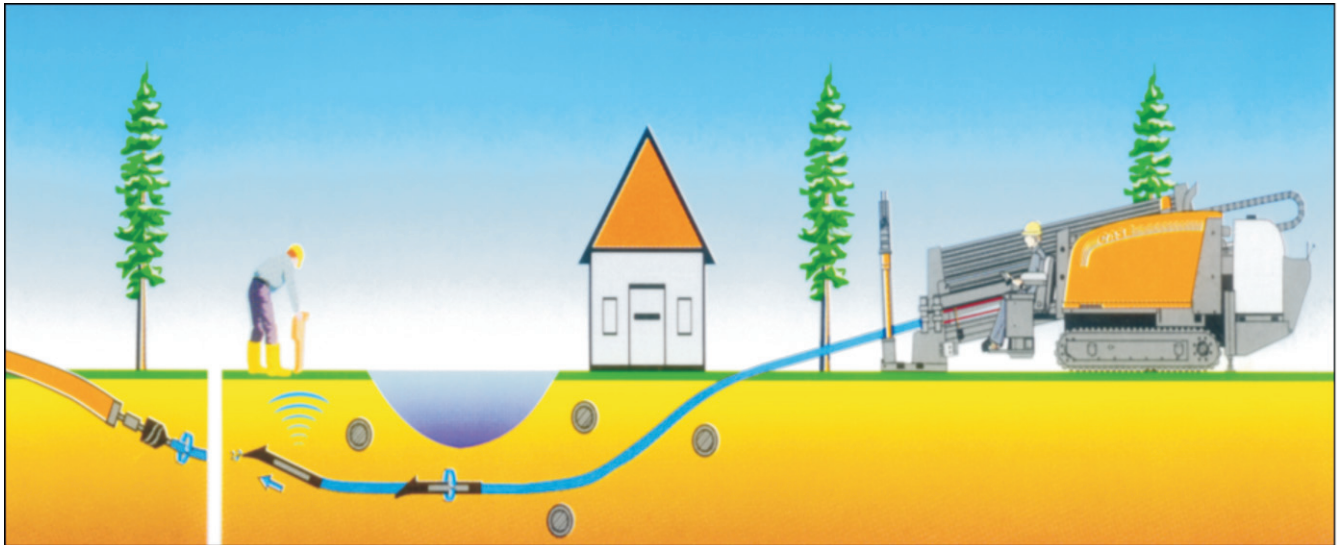

LESSO



SPIROLITE (M) SDN. BHD.

A member of CHINA LESSO GROUP HOLDINGS LIMITED

(21438-U) (197401004289) (SST no.W10-1808-22000358)

Address : Lot 4, Jalan P/2A, Kawasan Perindustrian Bangi,
43650 Bandar Baru Bangi, Selangor, Malaysia

Tel : +603 8925 0306
Fax : +603 8925 3568
E-mail : enquiries@spiro-lite.my
Web : www.spiro-lite.my

Stock Code: 2128.HK

* This catalog has been prepared as a support guide. Under no circumstance shall LESSO assume any liability or responsibility with the information in this catalog. Every effort has been made by LESSO to provide accurate and up to date information.

All Rights Reserved



Website-official